

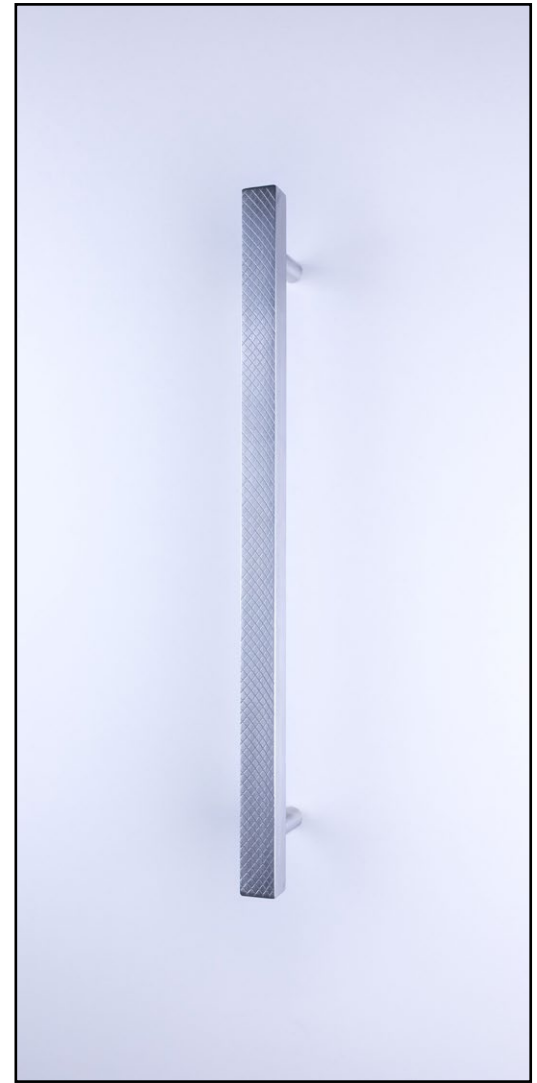

DALE DOOR RAIL

Dale is Dave's square brother. After knurling round objects for over 100 years, we thought why can't flat surfaces join the party? The Dale rail features a flat knurl pattern on its front face adding a three-dimensional detail to a minimal door rail. This pattern is produced using a custom tool developed by the clever people at Savage Design making it unique to the brand.

Milled from solid brass and stainless steel it is left raw in order to age like your favourite pair of jeans. A quick polish however will turn your handles back to new and crank your doors up to eleven. Our pre aged finish, aged bronze, is also available that will mature with time and use.

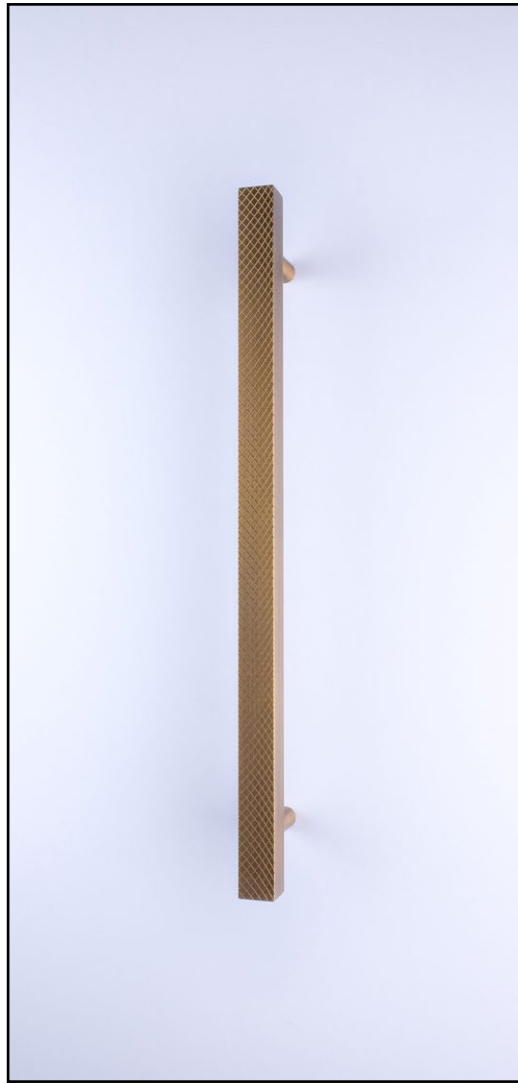
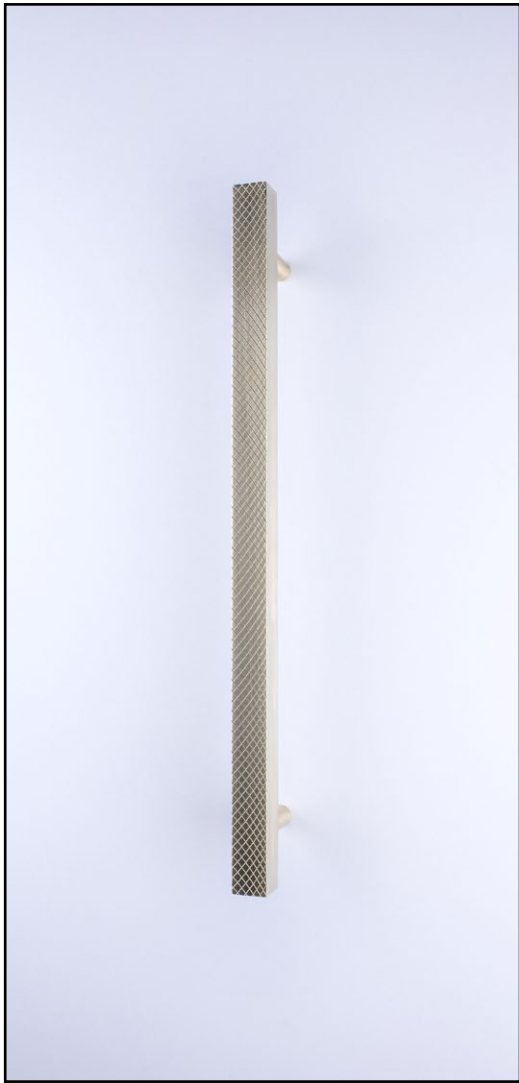

Brass (BR)

Aged Bronze (BO)

Blackened Brass (BB)

Stainless Steel (SS)

MATERIAL

Solid Brass*
 Solid Stainless Steel
 Aged Bronze*
 Blackened Brass*

* Living finish

SUPPLIED

1 x Rail / 2 x Screw (M4 x 25mm csk stainless steel)

Rear Fixing.

Screws provided suit doors / drawers

16mm - 18mm Thick.

INSTALLATION

Door or drawer - ø6mm hole.

**DIMENSIONS
 WEIGHTS**

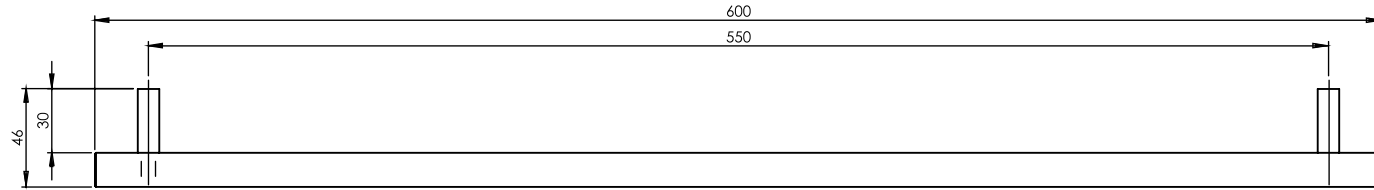

1.4kg approx.

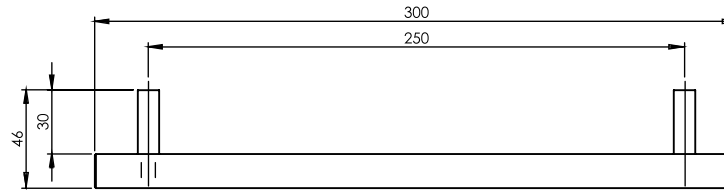

0.7kg approx.

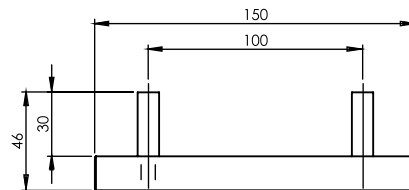

0.4kg approx.

CARE INSTRUCTION

Dust with a clean micro fiber cloth. Wipe down with a damp micro fiber cloth.
 Do not use abrasives. Do not use harsh chemicals. Warm mild soapy water can be used on stubborn dirt.
 Dry surface after cleaning with a clean cloth.

LIVING FINISHES

This product is made from raw material and will patina over time and with use. To find out more visit:

savagedesign.com.au/portfolio/living_finishes/