

## **VOLARE WALL SCONE**

Perfect for hallways, corridors or for corners of a room where a traditional floor lamp would take up floor space, the Volare is a minimal wall sconce washing walls mounted vertically or horizontally with only a short 59mm projection off the wall face.

The name Volare, Italian for 'fly', relates to the inhouse manufacturing technique we use to achieve the unique pattern in the front of the rail. These lines fanning out suggest movement and add texture and depth to the wall it resides on.

The Volare features an IP65 rated LED strip light with an external driver and suitable for outdoor and wet area use.

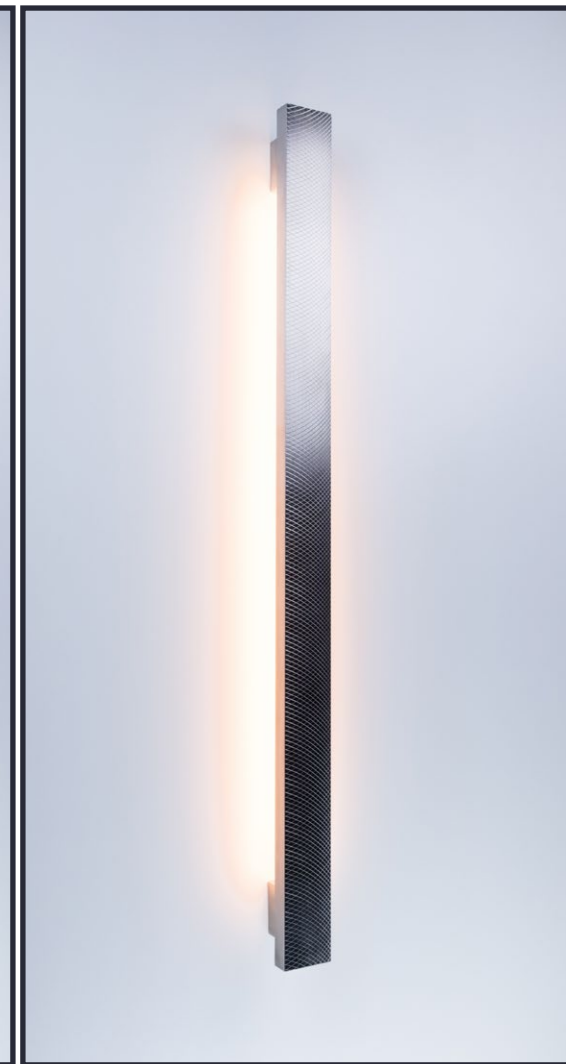
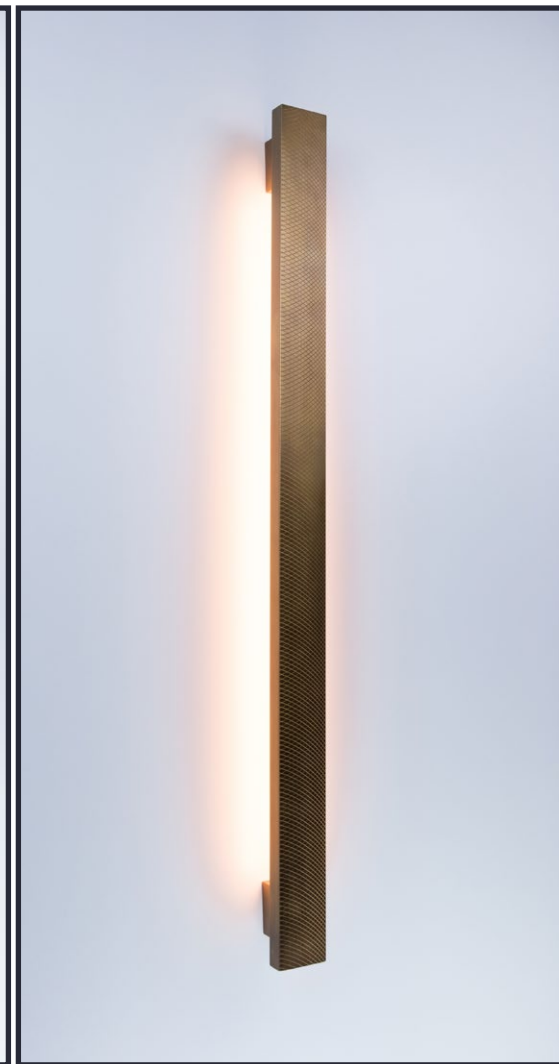
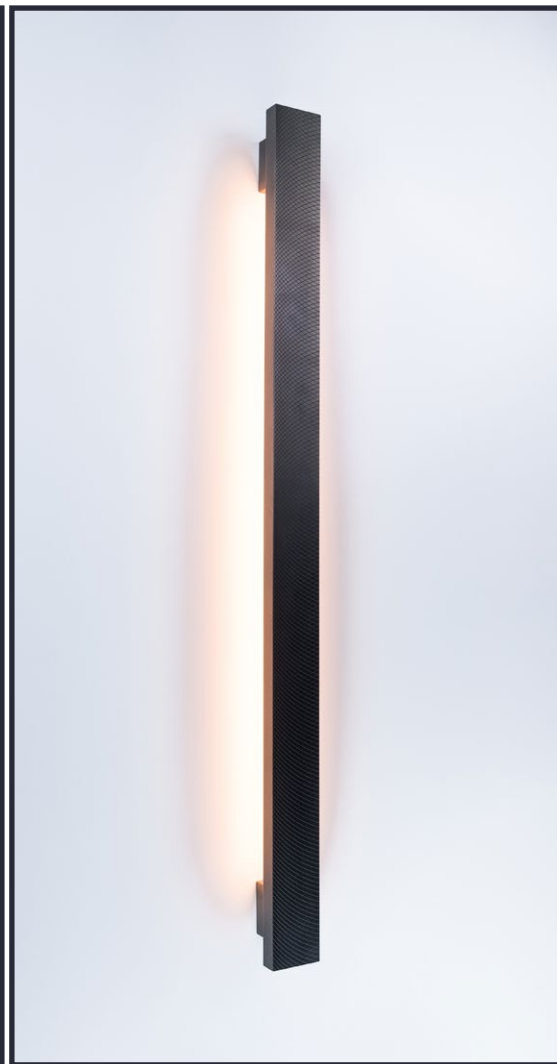
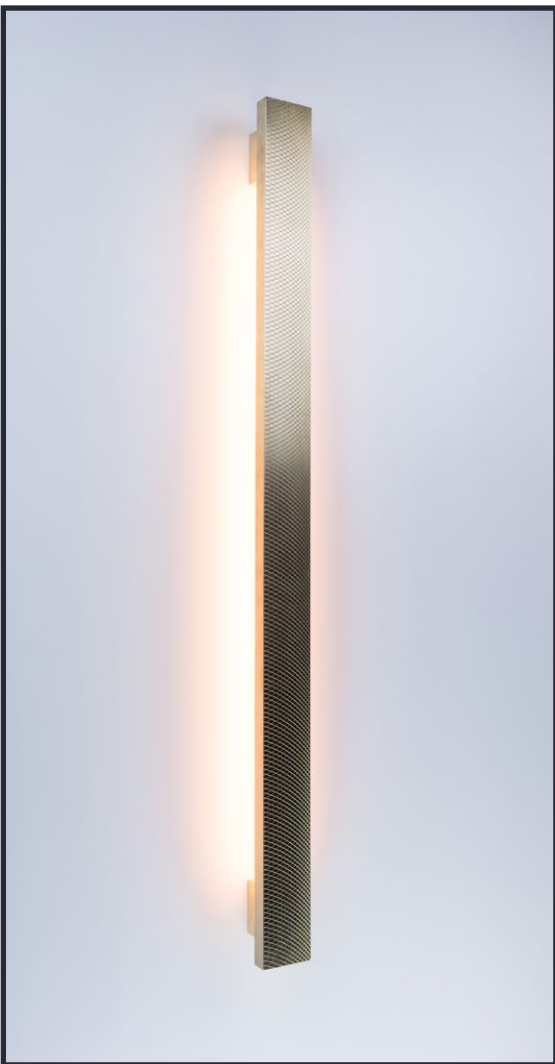

**MATERIAL**

Solid Brass\*  
 Solid Stainless Steel  
 Aged Bronze\*  
 Blackened Brass\*

\* Living finish

**INCLUDED**

Machined rail + Machined Stanchions  
 Bushes, Grub Screws and Wall Screws  
 LED Strip + Diffuser IP65  
 Driver (remote)

**INSTALLATION**

Must be installed by a qualified electrician

**LIGHT SOURCE**

LED Strip light Warm White  
 2700K / 120L / 20W / 1,700 Lumen p/m  
 IP65 Rated

**VOLTAGE**

240v - Mains must be connected to driver  
 DO NOT connect light directly into mains

**WEIGHT**

5 kg each

**DIMENSIONS**

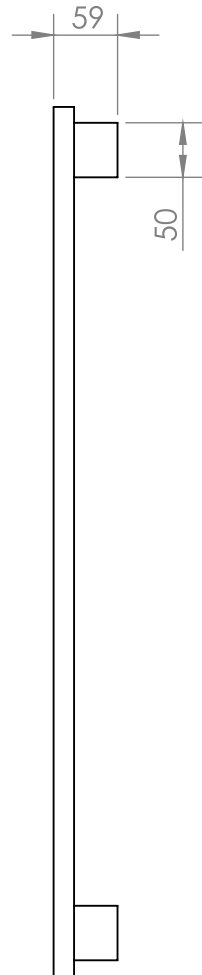
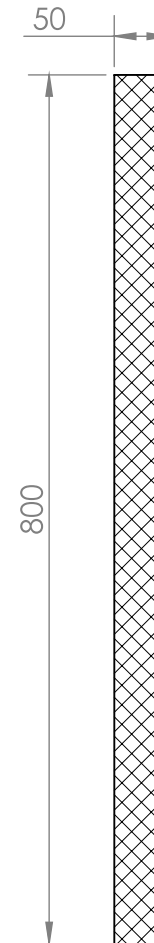
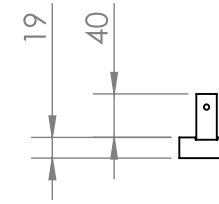

**USEAGE**

Suitable for indoor and outdoor use.

**CARE INSTRUCTION**

Dust with a clean micro fiber cloth. Wipe down with a damp micro fiber cloth. Do not use abrasives. Do not use harsh chemicals. Warm mild soapy water can be used on stubborn dirt. Dry surface after cleaning with a clean cloth.

**LIVING FINISHES**

This product is made from raw material and will patina over time and with use. To find out more visit:

[savagedesign.com.au/portfolio/living\\_finishes/](http://savagedesign.com.au/portfolio/living_finishes/)

- 1. Mark out fixing and cable hole positions
- 2. Drill cable hole through
- 3. Screw bushes to wall\*

- 4. Feed and connect cable
- 5. Push light onto bushes
- 6. Fit grub screws top and bottom

\*pre-drilling may be required  
wall plugs may be required  
at installers discretion

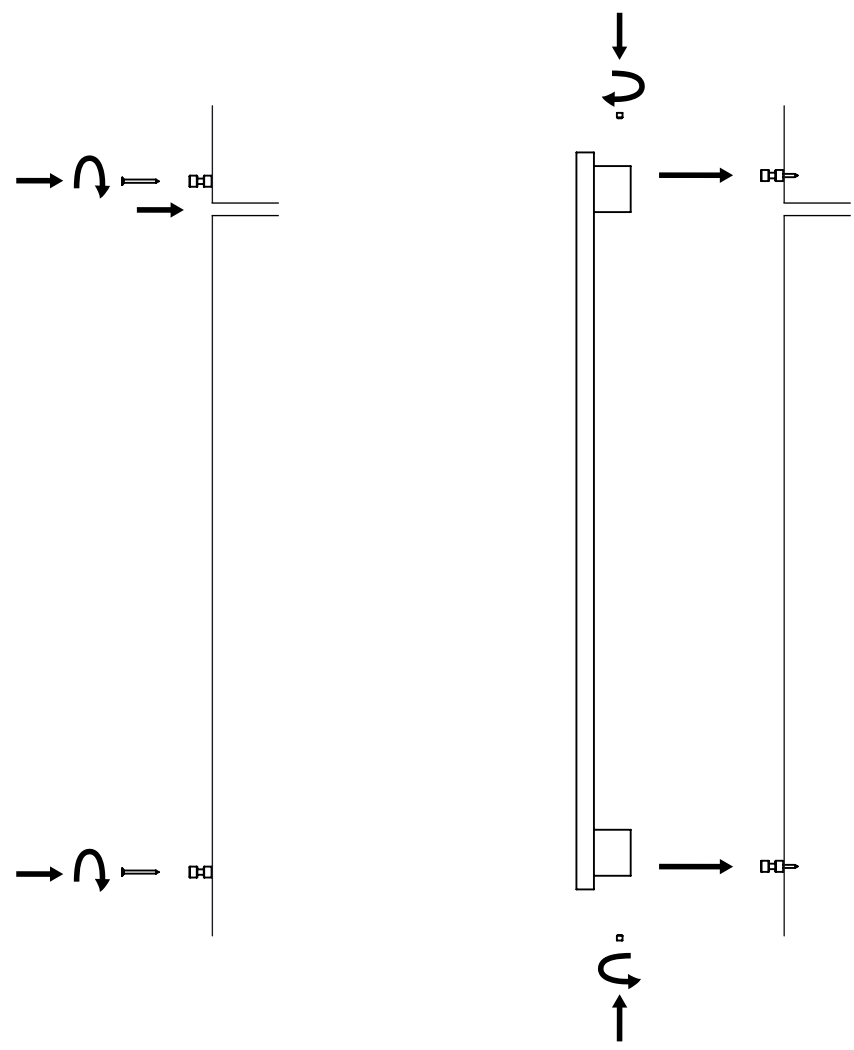

Volare dimensions

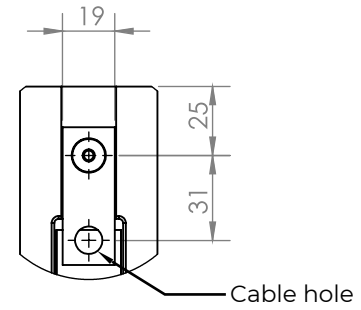
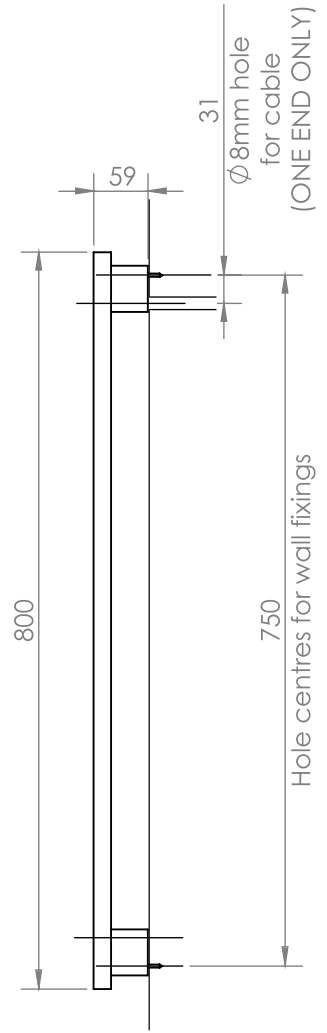

DETAIL B  
SCALE 1:2

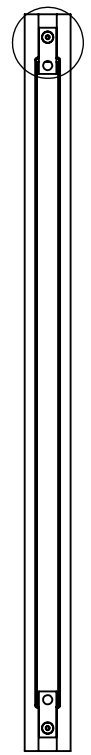

Cable can come out of the top, bottom, left or right depending on orientation of the light.